

UTILITY & EMERGENCY CONTACTS

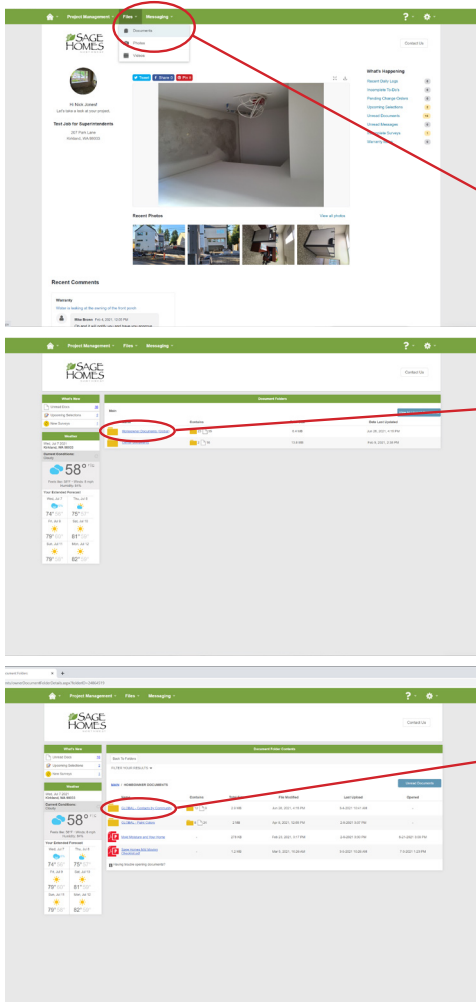

1. Sign onto your BuilderTrend homeowner page. <https://buildertrend.net/> (if you have not been given access to your BuilderTrend page, please contact sales@saghomesnw.com)

2. At the top green bar select "Files"

3. Scroll down and click on "Documents"

4. In the documents page, you have access to your PSA documents and "Homeowner Documents". Click on the "Homeowner Documents" for access to details on your interior and exterior paint color details, "Mold & Moisture and Your Home", "Sage Homes Moving Checklist" and more.

5. For your Contacts, click on "GLOBAL - Contacts by Community."

6. Select your community and open the PDF for your utility and emergency contact information.

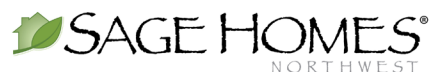

Persons in photos do not reflect racial preference and housing is open to all without regard to race, color, religion, sex, handicap, familial status or national origin. Prices, plans, and terms are effective on the date of publication and subject to change without notice. Depictions of homes or other features are artist conceptions. Hardscape, landscape, and other items shown may be decorator suggestions that are not included in the purchase price and availability may vary. © 2021 Sage Homes Northwest®